

Lower Thames Crossing
6.2 Environmental Statement Figures
Figure 8.32 - Compensation Area
Phase 1 Survey
(Clean version)

APFP Regulation 5(2)(a)

Infrastructure Planning (Applications:
Prescribed Forms and Procedure)
Regulations 2009

Volume 6

DATE: December 2023
DEADLINE: 9

Planning Inspectorate Scheme Ref: TR010032
Application Document Ref: TR010032/APP/6.2

VERSION: 2.0

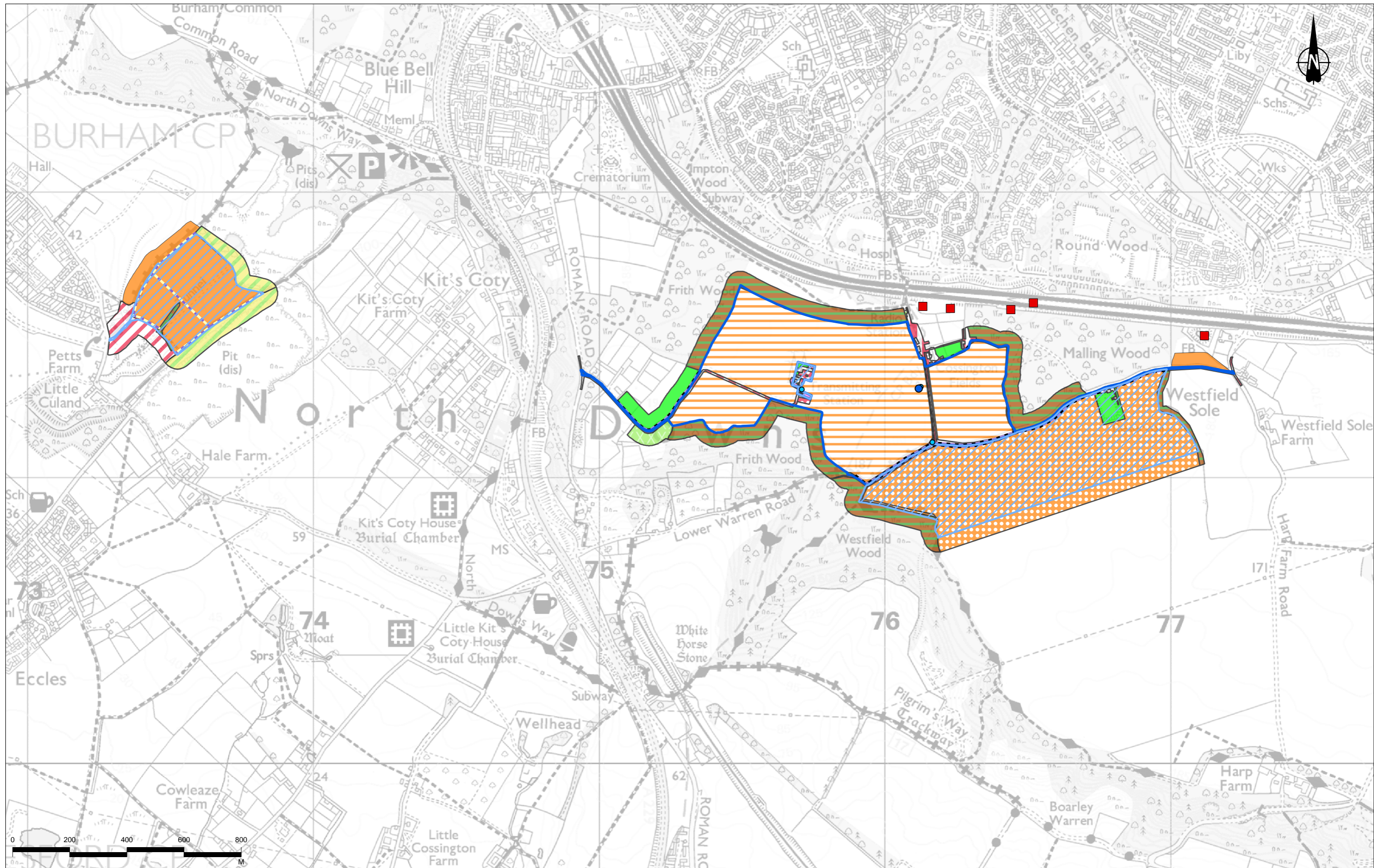

Contains Ordnance Survey data. © Crown copyright and database rights 2022. Ordnance Survey 100030649

P02	S8	16/08/2022	DCO Application	CD	SM	BF
P03	S9	27/11/2023	Deadline 9	CD	SM	BF
Rev	Status	Rev. Date	Purpose of revision	Drawn	Check'd	Approved

Legend	
	Order Limits
	Compensation area for nitrogen deposition - Land included in proposals
	Compensation area for nitrogen deposition - Land previously proposed, now removed
	Desk-assessed waterbody
	Surveyed waterbody
	Habitat - point
Habitat type	
	c - Cropland
	c1a - Arable field margins
	c1a5 - Arable margins sown with tussocky grasses
	c1c - Cereal crops
	c1d - Non-cereal crops
	g2 - calcareous grassland
	g3c - Other neutral grassland
	g3c6 - Lolium-Cynosurus neutral grassland
	g4 - Modified grassland
	h3h - Mixed scrub
	s1a9 - Tall herb communities
	u1 - Built-up areas and gardens
	u1b - Developed land, sealed surface
	u1b5 - Buildings
	u1c - Artificial unvegetated unsealed surface
	w1f - Lowland mixed deciduous woodland
	w1g - Other woodland, broadleaved
	h2 - Hedgerow
	h2a - Hedgerow (priority habitat)

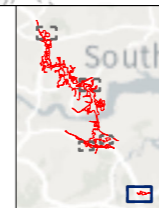

Client: national highways

Project: LOWER THAMES CROSSING

Status	PINS SUBMISSION	Original Size	A3	Revision	P03
Application Document Number	TR010032/APP/6.2	Scale	1:12,000		
Drawing Title	Figure 8.32 - Compensation Area Phase 1 Survey				
			Page 1 of 5		
Drawing Number	HE540039-CJV-EBD-SZP_EGNE0000000-DR-LE-50073				

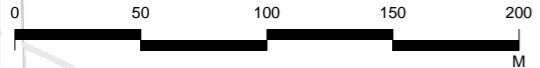
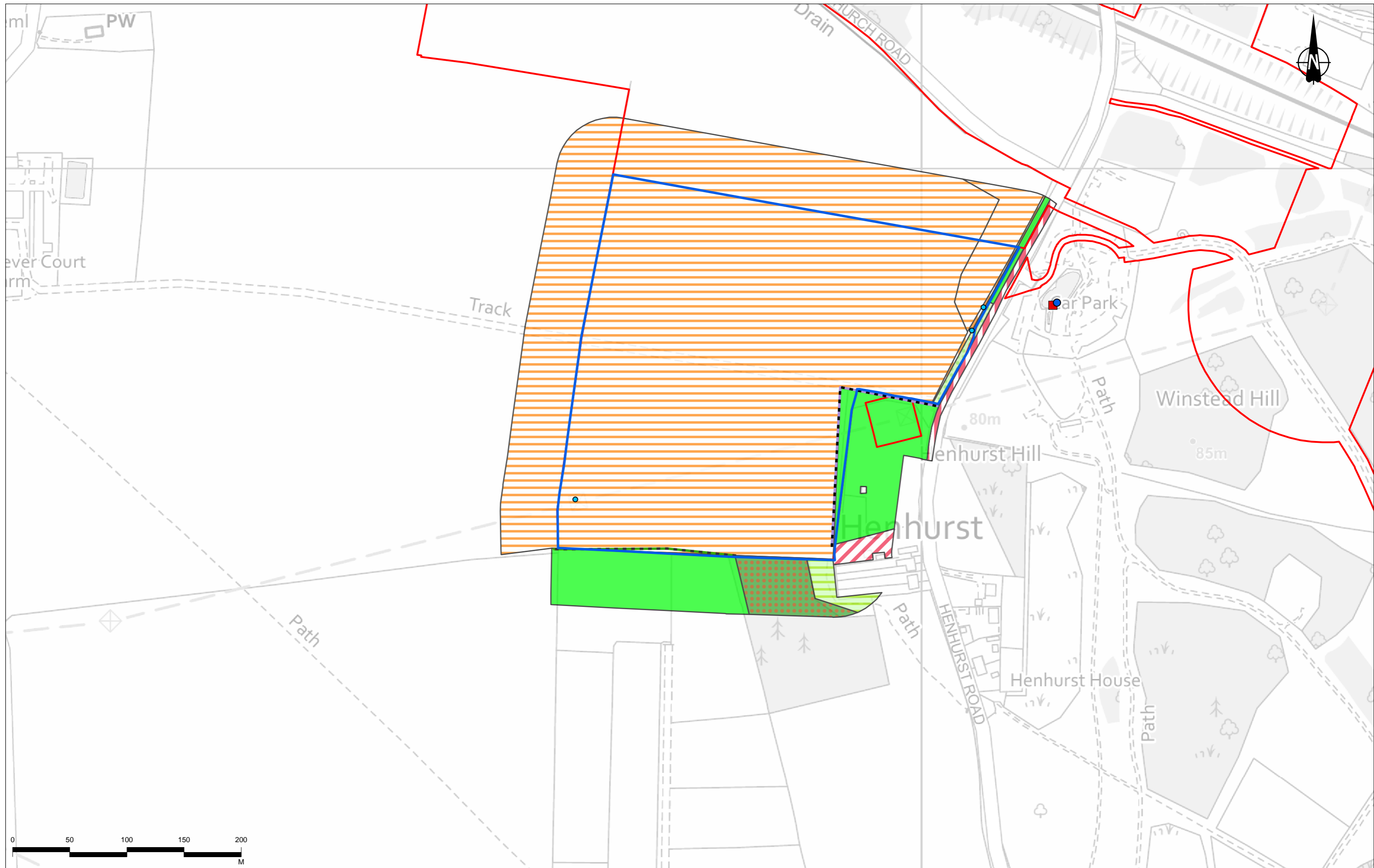

Contains Ordnance Survey data. © Crown copyright and database rights 2022. Ordnance Survey 100030649

P02	S8	16/08/2022	DCO Application	CD	SM	BF
P03	S9	27/11/2023	Deadline 9	CD	SM	BF
Rev	Status	Rev. Date	Purpose of revision	Drawn	Chkd	Appr'd

Legend

- Order Limits
- Compensation area for nitrogen deposition - Land included in proposals
- Desk-assessed waterbody

- Surveyed waterbody
 - Habitat - point
- Habitat type**
- c1a5 - Arable margins sown with tussocky grasses

- c1c - Cereal crops
- g3c - Other neutral grassland
- g3c5 - Arrhenatherum neutral grassland
- g4 - Modified grassland
- u1 - Built-up areas and gardens

- u1b - Developed land, sealed surface
- w1g - Other woodland, broadleaved
- h2a - Hedgerow (priority habitat)
- w1g6 - Line of trees

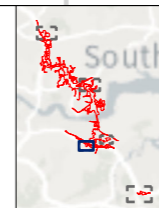

Client: **national highways**

Project: **LOWER THAMES CROSSING**

Status	PINS SUBMISSION	Original Size	A3	Revision	P03
Application Document Number	TR010032/APP/6.2	Scale	1:3,000		
Drawing Title	Figure 8.32 - Compensation Area Phase 1 Survey				
Page 2 of 5					
Drawing Number	HE540039-CJV-EBD-SZP_EGNE00000000-DR-LE-50073				

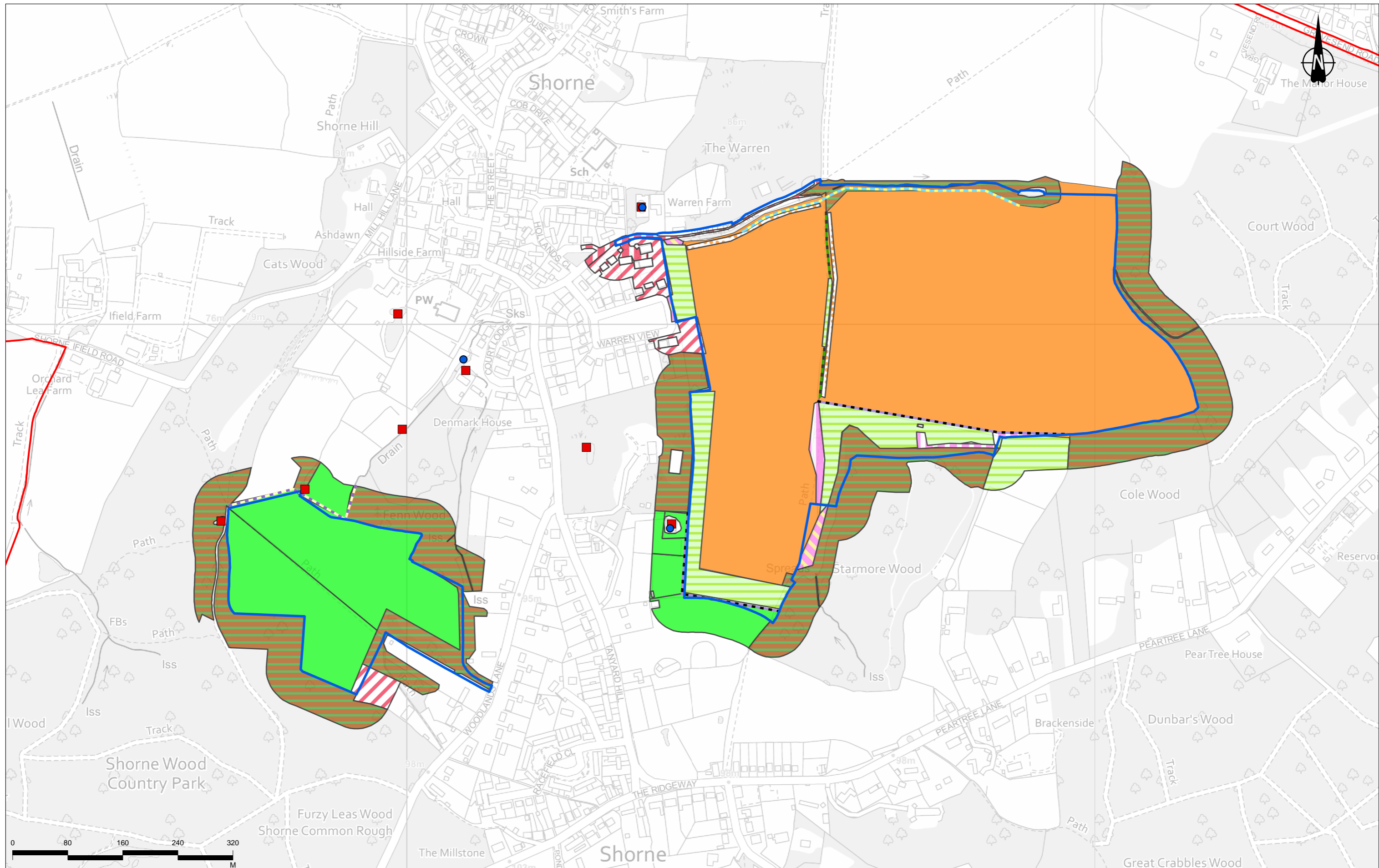

Contains Ordnance Survey data. © Crown copyright and database rights 2022. Ordnance Survey 100030649

P02	S8	16/08/2022	DCO Application	CD	SM	BF
P03	S9	27/11/2023	Deadline 9	CD	SM	BF
Rev	Status	Rev. Date	Purpose of revision	Drawn	Check'd	Apprv'd

Legend		Habitat type	
	Order Limits		c - Cropland
	Compensation area for nitrogen deposition - Land included in proposals		c1a - Arable field margins
	Desk-assessed waterbody		g3c - Other neutral grassland
	Surveyed waterbody		g4 - Modified grassland
			h3d - Bramble scrub
	h3h - Mixed scrub		w1f - Lowland mixed deciduous woodland
	u1 - Built-up areas and gardens		h2 - Hedgerow
	u1b - Developed land, sealed surface		h2a - Hedgerow (priority habitat)
	u1b5 - Buildings		r2b - Other river and stream
	u1c - Artificial unvegetated unsealed surface		w1g6 - Line of trees

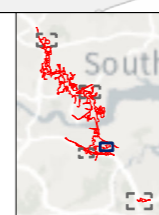

Client
 national highways
 Project
LOWER THAMES CROSSING

Status	PINS SUBMISSION	Original Size	A3	Revision	P03
Application Document Number	TR010032/APP/6.2	Scale	1:5,000		
Drawing Title	Figure 8.32 - Compensation Area Phase 1 Survey				
	Page 3 of 5				
Drawing Number	HE540039-CJV-EBD-SZP_EGNE0000000-DR-LE-50073				

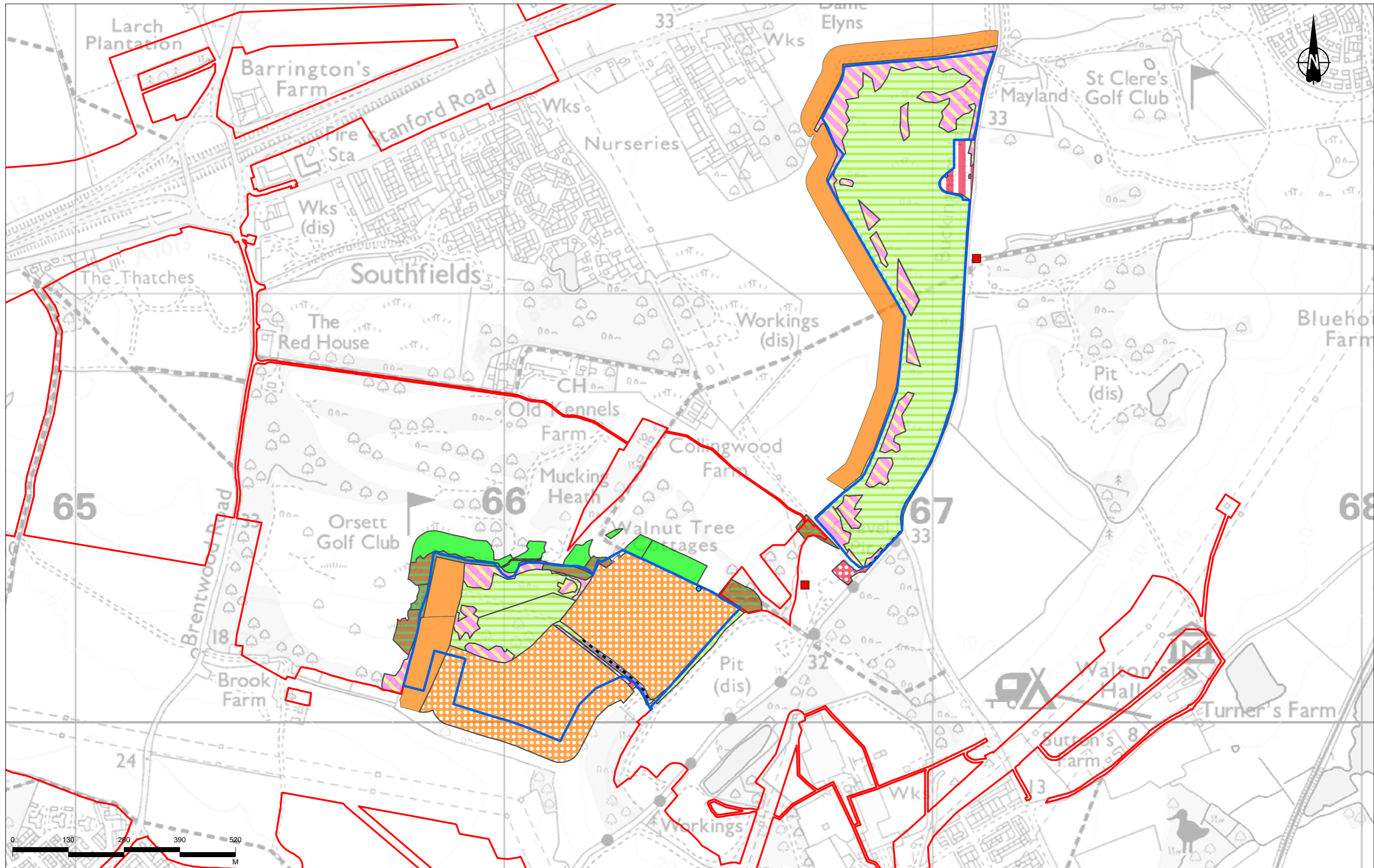

P02	S8	16/08/2022	DCO Application	CD	SM	BF
P03	S9	27/11/2023	Deadline 9	CD	SM	BF
Rev	Status	Rev. Date	Purpose of revision	Drawn	Chkd	Apprv'd

Legend

- Order Limits
- Compensation area for nitrogen deposition - Land included in proposals
- Desk-assessed waterbody
- Habitat - point

Habitat type

- c - Cropland
- c1d - Non-cereal crops
- g3c - Other neutral grassland
- g3c5 - Arrhenatherum neutral grassland

- g4 - Modified grassland
- h3d - Bramble scrub
- h3e - Gorse scrub
- h3h - Mixed scrub
- u1b - Developed land, sealed surface

- u1c - Artificial unvegetated unsealed surface
- w1f - Lowland mixed deciduous woodland
- w1f7 - Other lowland mixed deciduous woodland

- w1g - Other woodland, broadleaved
- h2 - Hedgerow
- h2a - Hedgerow (priority habitat)
- r2b - Other river and stream

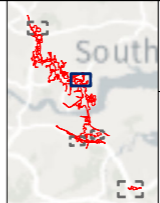

Client
 national highways
 Project
LOWER THAMES CROSSING

Status	PINS SUBMISSION	Original Size	A3	Revision	P03
Application Document Number	TR010032/APP/6.2	Scale	1:8,000		
Drawing Title	Figure 8.32 - Compensation Area Phase 1 Survey				
Drawing Number	HE540039-CJV-EBD-SZP_EGNE0000000-DR-LE-50073				

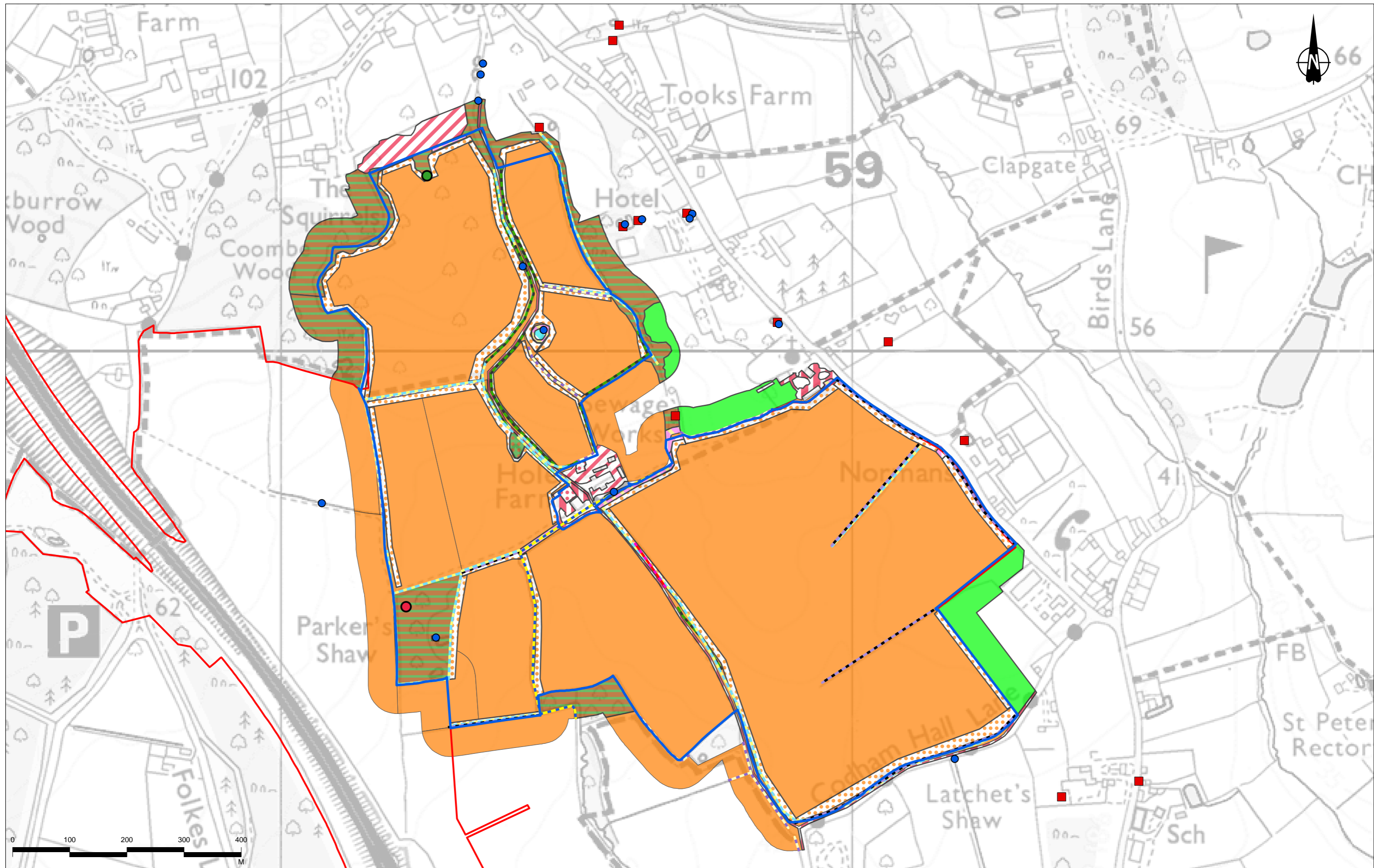

Contains Ordnance Survey data. © Crown copyright and database rights 2022. Ordnance Survey 100030649

P02	S8	16/08/2022	DCO Application	CD	SM	BF
P03	S9	27/11/2023	Deadline 9	CD	SM	BF
Rev	Status	Rev. Date	Purpose of revision	Drawn	Chkd	Apprvd

- Legend**
- Order Limits
 - Compensation area for nitrogen deposition - Land included in proposals
 - Desk-assessed waterbody
 - Surveyed waterbody

- Habitat type**
- c - Cropland
 - c1a - Arable field margins
 - g4 - Modified grassland

- h3d - Bramble scrub
- h3h - Mixed scrub
- r1a - Eutrophic standing water
- r2 - Rivers and lakes
- u1 - Built-up areas and gardens
- u1b - Developed land, sealed surface

- u1b5 - Buildings
- w1f - Lowland mixed deciduous woodland
- w1g - Other woodland, broadleaved
- h2 - Hedgerow
- h2a - Hedgerow (priority habitat)

- h2b - Other hedgerow
- r2 - River and stream
- r2b - Other river and stream
- u1b - Developed land; sealed surface
- w1g6 - Line of trees

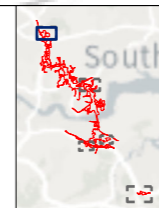

Client: **national highways**

Project: **LOWER THAMES CROSSING**

Status	PINS SUBMISSION	Original Size	A3	Revision	P03
Application Document Number	TR010032/APP/6.2	Scale	1:6,000		
Drawing Title	Figure 8.32 - Compensation Area Phase 1 Survey				
Page	Page 5 of 5				
Drawing Number	HE540039-CJV-EBD-SZP_EGNE0000000-DR-LE-50073				

If you need help accessing this or any other National Highways information, please call **0300 123 5000** and we will help you.

© Crown copyright 2023.

You may re-use this information (not including logos) free of charge in any format or medium, under the terms of the Open Government Licence. To view this licence:

visit www.nationalarchives.gov.uk/doc/open-government-licence/

write to the **Information Policy Team, The National Archives, Kew, London TW9 4DU**, or email psi@nationalarchives.gsi.gov.uk.

Mapping (where present): © Crown copyright and database rights 2023 OS 100030649. You are permitted to use this data solely to enable you to respond to, or interact with, the organisation that provided you with the data. You are not permitted to copy, sub-license, distribute or sell any of this data to third parties in any form.

If you have any enquiries about this publication email info@nationalhighways.co.uk or call **0300 123 5000***.

*Calls to 03 numbers cost no more than a national rate call to an 01 or 02 number and must count towards any inclusive minutes in the same way as 01 and 02 calls. These rules apply to calls from any type of line including mobile, BT, other fixed line or payphone. Calls may be recorded or monitored.

Printed on paper from well-managed forests and other controlled sources when issued directly by National Highways.

Registered office Bridge House, 1 Walnut Tree Close, Guildford GU1 4LZ

National Highways Limited registered in England and Wales number 09346363